

Product specification

M2M²

1. Scope

- Single outward opening doorsets
- Double outward opening doorsets
- Single inward opening doorsets
- Double inward opening doorsets

2. Sizing

All sizes shown are structural sizes in mm.

Variant	Min Height (mm)	Max Height (mm)	Min Width (mm)	Max Width (mm)
Single outward opening doorsets	1000	2930	740	1430
Double outward opening doorsets	1000	2930	1150	2600
Single inward opening doorsets	1000	2930	600	1430
Double inward opening doorsets	1000	2930	900	2600

Note:

- Leaf and a half doorsets are available, with a minimum passive leaf width of 400mm passive and 750mm active.
- Side and/or over panels can be used in a modular fashion to secure larger openings.
- Outward opening double passive leafs can only be fitted with spring bolts.
- Inward opening double doors with fixed side or top panel can only be fitted with spring bolts on the passive
- Double inward and double inward with removable top panel can have spring bolts, MSTB or HSTB tower bolts

3. Locking Options

- MICO Elite panic escape, manual, automatic, or electromechanical deadlocking single point locking
- External access via MICO USCH cylinder guard with Scandinavian oval cylinders, as standard
- Available also to suit round or rim cylinders
- Tower bolts extended to a reachable height on larger doorsets

4. Additional Options

- Vision panels (standard sizes in mm are 203x356, 203x762, 457x457)
- Bladed louvre cartridges
- Stays and closers (M100 and TS83, as standard)
- Fixed side panels
- Fixed/removable over panels

Product specification

M2M²

5. Security Rating

M2M² doors are LPCB certified to LPS 1175: Issue 7 Security Rating 2 (certificate number 312f).

6. Fire Rating

M2M² doors are available with a fire rating up to FD240, providing integrity fire resistance for up to 240 minutes, certified by Exova under the CERTIFIRE scheme (certificate number CF5107).

7. Acoustic Rating

Tested by Lorient to BS EN ISO 101402: 2010, certain M2M² doors are available with acoustic ratings from Rw40 to Rw42, providing 40dB (double doorsets) to 42dB (single doorsets) of noise reduction, depending on specification.

8. Leaf construction

Leaf Thickness	66mm
Leaf Material	Outerskins 1.5mm THK Zintec, stainless steel, or Magnelis Internal plating to suit locking requirement Armoured steel, where required
Hinges	6no. hinges per leaf Choice of 100mm lift off hinges or grade 13 butt hinges Protected by 9no. hooked dog bolts per leaf
Astragal	10mm steel astragal
Lifting points	M10 lifting point per leaf

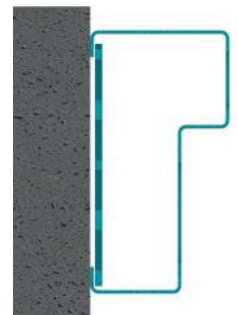

Frame profile

9. Frame Construction

Frame profile	110mm deep
Frame material	1.5mm THK Zintec, stainless steel, or Magnelis
Construction method	Butt jointed frame sections, as standard Fully welded frame available at an extra cost
Reinforcing	3mm chassis system (no adjusters)
Threshold	Steel or aluminium available No still option available

Product specification

M2M²

10. Standard Details

Finish	Polyester powder coated, as standard Wood effect finish available at an extra cost
U'Value	No data available
Weight	Circa 60kg/m ²