

## Product specification

# M2M<sup>4</sup>

### 1. Scope

- Single outward opening doorsets
- Double outward opening doorsets
- Single inward opening doorsets

### 2. Sizing

All sizes shown are structural sizes in mm.

| Variant                         | Min Height (mm) | Max Height (mm) | Min Width (mm) | Max Width (mm) |
|---------------------------------|-----------------|-----------------|----------------|----------------|
| Single outward opening doorsets | 1000            | 2930            | 600            | 1430           |
| Double outward opening doorsets | 1000            | 2930            | 900            | 2600           |
| Single inward opening doorsets  | 1000            | 2930            | 600            | 1430           |

Note:

- Side and/or over panels can be used in a modular fashion to secure larger openings.

### 3. Locking Options

- MICO Abryll panic escape, manual, automatic, and electromechanical deadlock single point locking
- Double panic bar variant also available (panic bars fitted to both leaves of double doorsets)
- External access via MICO USCH cylinder guard with Scandinavian oval cylinders, as standard (available also to suit round or rim cylinders)
- Passive leaf fitted with heavy duty tower bolts, as standard, or secondary multipoint lock (tower bolts extended to a reachable height on larger doorsets)

### 4. Additional Options

- Certified vision panel (427 mm - 833mm x 274 mm - 508mm) incorporating LPS 1270 approved specialist laminated security glass
- Surelock max air xa4 louvre panels
- Range of stays and closers (M100 and TS83, as standard)
- Fixed side and/or over panels
- Hinged over panel

### 5. Security Rating

M2M Doors are LPCB Certified to LPS 1175: Issue 7 Security Rating 4 (certificate number 312e).

## Product specification

# M2M<sup>4</sup>

### 6. Fire Rating

M2M4 doors are available with a fire rating up to FD240, providing integrity fire resistance for up to 240 minutes, certified by Exova under the CERTIFIRE scheme (certificate number CF5107).

Note:

- 2/3 point locking systems are not fire rated.
- Vision panels reduce the doorset's fire rating to FD60.
- Doors with louvres are not fire rated.

### 7. Leaf construction

|                |  |
|----------------|--|
| Leaf Thickness | 66mm   |
| Leaf Material  | Outerskins 1.5mm THK Zintec, Stainless steel, or Magnelis  |
| Reinforcing    | Internal plating to suit locking requirement<br>Armoured steel, where required   |
| Hinges         | 6no. hinges per leaf<br>Choice of 126mm lift off hinges or grade 13 butt hinges<br>Protected by 9no. hooked dog bolts per leaf |
| Astragal       | 10mm steel astragal  |
| Lifting points | M10 lifting point per leaf   |

### 8. Frame Construction

|                     |   |
|---------------------|---|
| Frame profile       | 110mm deep  |
| Frame material      | 2mm THK Zintec or stainless steel   |
| Construction method | Butt jointed frame sections, as standard<br>Fully welded frame available at an extra cost |
| Reinforcing         | 3mm chassis system (no adjusters)   |
| Threshold           | Steel or aluminium available  |

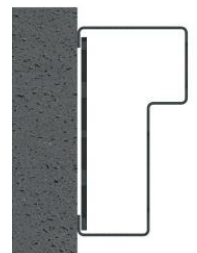

Frame profile

### 9. Standard Details

|         |   |
|---------|---|
| Finish  | Polyester powder coated, as standard<br>Wood effect finish available at an extra cost |
| U'Value | No data available   |
| Weight  | Circa 75kg/m <sup>2</sup>   |